

# HDH1830H

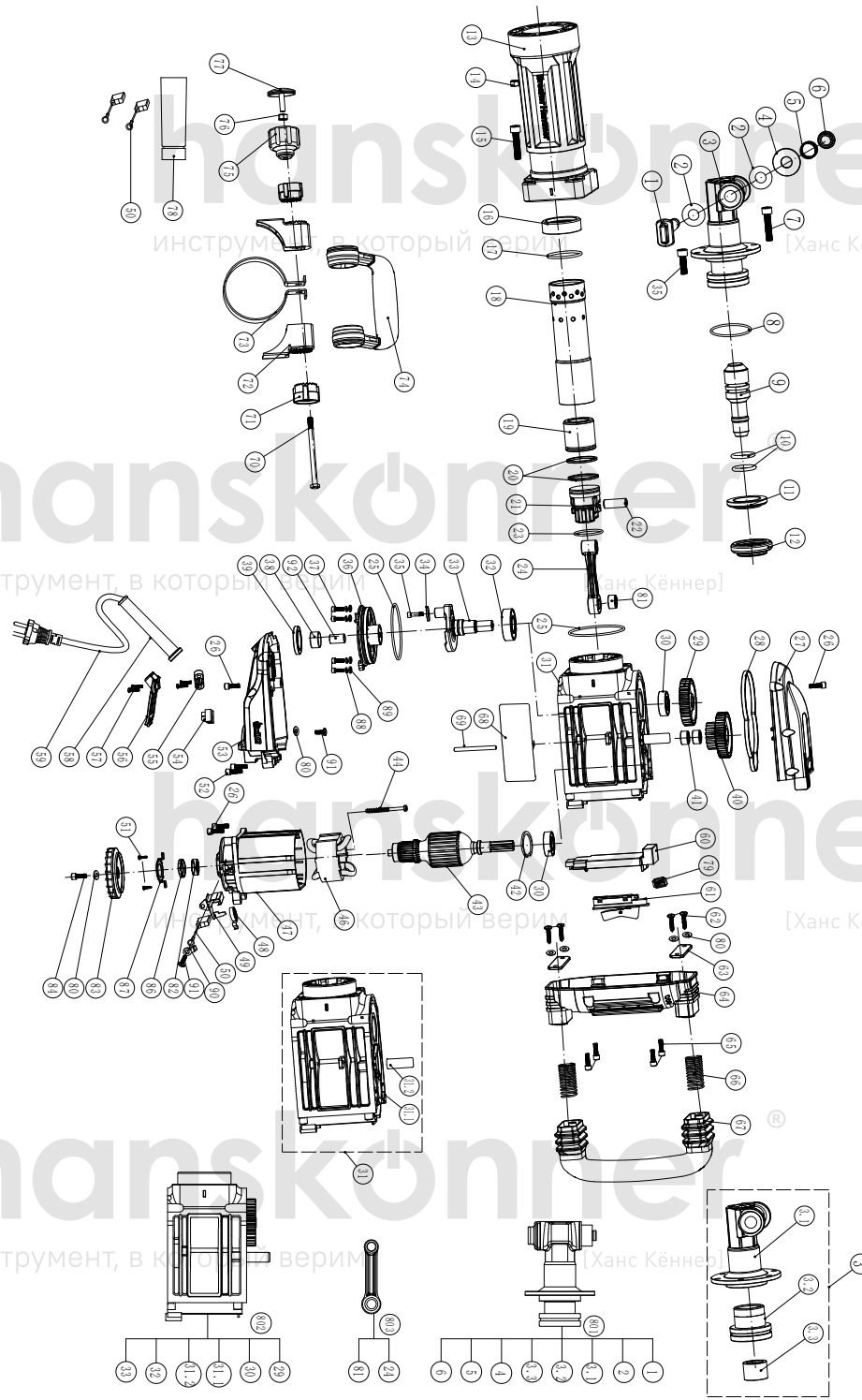

No.	Description	No.	Description
1	Locking Lever	46	Stator 110-120V
2	Clamp ring	47	Stator Assy's
3	Front Cover Assembly	48	Helical spring
3.1	Front Cover	49	Carbon brush wire
3.2	Locating Sleeve	50	Carbon Brush 220-240V
3.3	Hammer Ring	50	Carbon Brush 110-120V
4	Spring set	51	ST4.2×10 Tapping Screw
5	Lever Spring	52	Hex .Socket Bolt M6x25
6	Spring Cover	53	Fan Cover
7	Hex .Socket Bolt M8×55(12.9)	54	Rivet
8	O RingΦ60xΦ3.3	55	Cord Clip
9	Impact Hammer	56	Blind flange
10	Fluorin O-RingΦ30.2xΦ5.1	57	ST4.2×16 Tapping Screw
11	Limit ring	58	Cord Armor
12	Shock absorption ring	59	Cord
13	Aluminum Head	60	Switch seat
14	M8×9 Nut	61	Switch 220-240V
15	Hex .Socket Bolt M10×55	61	Switch 110-120V
16	Cylinder seat	62	ST4.8×35 Tapping Screw
17	Shock Absorption Ferrule	63	Guide plate
18	Cylinder	64	Handle seat
19	Impact Piston	65	Hex .Socket Bolt M6×15(12.9)
20	Piston ring	66	Shock Absorption Spring
21	Gas Press Piston	67	Main Handle
22	Piston PinΦ14×39	68	Scutcheon(Front Side)
23	O-RingΦ39.4xΦ3.1	68	Scutcheon(Reverse Side)
24	Connecting Rod Ass'y	69	PinΦ6×75
25	O-RingΦ87×Φ3.5	70	Hex .Socket Bolt M8×150
26	Hex .Socket Bolt M6×20	71	Disk with gap
27	Cover	72	Clamping
28	Airproof Ring	73	Side Handle Ass'y Steel Tie
29	Final Gear	74	Side Handle
30	Ball Bearing 6203RS	75	Function Knob
31	Housing Assembly	76	M8×6.4 Nut
31.1	Housing Ass'y	77	Function Knob cover
31.2	PinΦ16×60	78	Oil Bottle
32	Ball Bearing 6205 RS	79	Electricity Feels
33	Crank Shaft	80	Flat Washer Φ5.5xΦ16x1.5
34	Φ8 Flat Washer Φ24xΦ8.4x2	81	HK162216 Needle Bearing
35	Hex .Socket Bolt M8×30 (12.9)	82	NSK6000 Ball Bearing
36	Oil Tank Cover	83	Fan
37	Hex .Socket Bolt M4×12	84	Hex .Socket Bolt M5×14(12.9)
38	Wool block1	85	ST4.2×14 Tapping Screw
39	Cover plate	86	6000 Bearing Ring
40	Double teeth	87	Bearing Washer
41	HK1612 Needle Bearing	801	Front Cover Assembly 2
42	Φ40 Retaining Ring	802	Housing Assembly 2
43	Armature 220-230V	803	Connecting Assembly
43	Armature 240V	88	Φ4 Spring Washer
43	Armature 110-120V	89	Φ4 Flat Washer
44	ST4.8×65 Tapping Screw	90	Retainer
46	Stator 220-230V	91	ST4.2×10 Tapping Screw
46	Stator 240V	92	Wool block 2